

cendrex

Odd-size doors **faster!**



LEED V4 compliant

MULTIPURPOSE

FIRE-RATED

RECESSED

SPECIALTY

SECURITY

FLOOR HATCH

ROOF HATCH

Check out our
ELEGANCE COLLECTION

ACCESS DOORS
C A T A L O G

Visit our website at www.cendrex.com
and request an online quote today!

The **CONTOUR**'s slightly bevelled panel closes over the flange, thereby creating a truly modern appearance. A hidden magnetic closing mechanism gives the **CONTOUR** an elegant and subtle finish. Due to the choice of materials used and shortened assembly time, this door is considered an economical option. Installation is quick and easy. It is suitable for application on walls or ceilings composed of any material

DESCRIPTION

- Material:** 16 gauge steel frame and door
- Hinge:** Concealed double arm pantograph system
- Lock / latch:** Concealed magnets for locking mechanism
- Finish:** High quality white powder coat finish. May be used as is or painted over with finished paint coat
- Packaging:** Individually wrapped. 1 per box

POPULAR OPTIONS

[see p. 20-23 for complete list of options]

- Material:** Galvanneal steel
- Lock / latch:** Key operated cylinder cam latch, hex head cam latch, pinned hex head cam latch, handle operated cam latch, mortise preparation for cylinder (cylinder optional).
- Retaining cables:** For doors > 12" X 12"
- Gasketing:** Neoprene

LEED ready: This product contributes to LEED® credits. Visit www.cendrex.com for more information.

Elegance collection



CONCEALED ACCESS DOORS



Table of standard sizes

[other sizes available upon request]

DOOR SIZE W x H inches (MM)	ROUGH CEILING OPENING inches	WEIGHT LBS KG
8 1/4 x 8 1/4 (210 x 210)	8 1/2 x 8 1/2 (216 x 216)	3 1.4
8 1/4 x 12 (210 x 304)	8 1/2 x 12 1/4 (216 x 310)	4 1.8
10 x 10 (254 x 254)	10 1/4 x 10 1/4 (260 x 260)	4 1.8
12 x 12 (304 x 304)	12 1/4 x 12 1/4 (310 x 310)	6 2.7
12 x 18 (304 x 457)	12 1/4 x 18 1/4 (310 x 464)	7 3.2
14 x 14 (355 x 355)	14 1/4 x 14 1/4 (362 x 362)	8 3.6
16 x 16 (406 x 406)	16 1/4 x 16 1/4 (413 x 413)	9 4.1
18 x 18 (457 x 457)	18 1/4 x 18 1/4 (464 x 464)	10 4.5
18 x 24 (457 x 609)	18 1/4 x 24 1/4 (464 x 616)	13 5.9
20 x 20 (508 x 508)	20 1/4 x 20 1/4 (514 x 514)	13 5.9
22 x 22 (558 x 558)	22 1/4 x 22 1/4 (565 x 565)	15 6.8
22 x 30 (558 x 762)	22 1/4 x 30 1/4 (565 x 768)	17 7.7
22 x 36 (558 x 914)	22 1/4 x 36 1/4 (565 x 920)	19 8.6
24 x 24 (609 x 609)	24 1/4 x 24 1/4 (616 x 616)	17 7.7
24 x 30 (609 x 762)	24 1/4 x 30 1/4 (616 x 768)	19 8.6
24 x 36 (609 x 914)	24 1/4 x 36 1/4 (616 x 920)	24 10.9

Your odd sizes:
Made in 5 days

**CLEAN LOOK DUE TO
HIDDEN MAGNETIC
CLOSING MECHANISM**

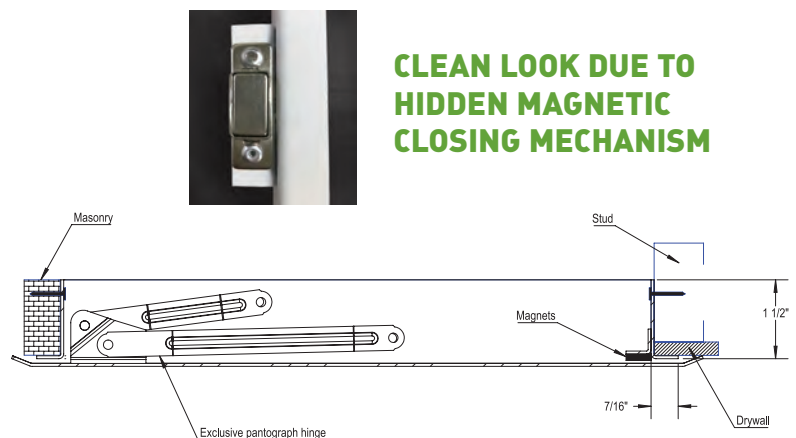

EDG-GYP

FLUSH REMOVABLE ACCESS DOOR WITH DRYWALL BEAD FLANGE

The **EDG-GYP** is practical with removable, concealed spring and pin type hinges and push-to-close latches. Once the corner bead plastered, the door becomes almost invisible. The **EDG-GYP** is durable and economical since the door and the frame are composed of steel based materials. It is perfect for application on walls or ceilings composed of any material

DESCRIPTION

- Material:** 16 gauge cold rolled steel
Frame with corner bead flange
- Hinge:** Concealed spring hinge
- Lock / latch:** Concealed push latch
- Finish:** Rounded mitered corners
High quality white powder coat finish
- Removable door:** Yes. (safety cables)
- Packaging:** Individually wrapped. 1 per box

POPULAR OPTIONS

[see p. 20-23 for complete list of options]

- Material:** Stainless steel, galvanized steel

LEED ready: This product contributes to LEED® credits.
Visit www.cendrex.com for more information.

Elegance collection



CONCEALED ACCESS DOORS

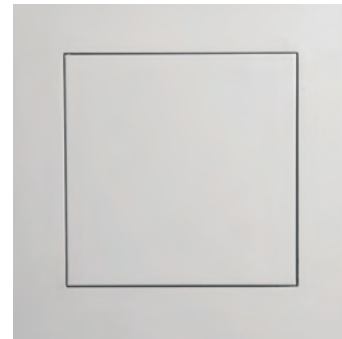

CONCEALED HINGES AND PUSH LATCH

Table of standard sizes

[other sizes available upon request]

DOOR SIZE W x H inches (MM)	ROUGH CEILING OPENING inches	WEIGHT LBS KG
6 x 6 (152 x 152)	6 1/4 x 6 1/4 (159 x 159)	2.2 1
8 x (203 x 203)	8 1/4 x 8 1/4 (210 x 210)	3.1 1.4
8 x 12 (210 x 304)	8 1/4 x 12 1/4 (216 x 311)	4.2 1.9
10 x 10 (254 x 254)	10 1/4 x 10 1/4 (260 x 260)	4.2 1.9
12 x 12 (304 x 304)	12 1/4 x 12 1/4 (310 x 310)	5.45 2.47
12 x 16 (304 x 406)	12 1/4 x 12 1/4 (310 x 413)	6.55 2.97
12 x 18 (304 x 457)	12 1/4 x 18 1/4 (310 x 464)	7.5 3.2
12 x 24 (304 x 609)	12 1/4 x 24 1/4 (310 x 464)	9.9 4.5
14 x 14 (355 x 355)	14 1/4 x 14 1/4 (362 x 362)	6.55 2.97
16 x 16 (406 x 406)	16 1/4 x 16 1/4 (413 x 413)	8.1 3.7
18 x 18 (457 x 457)	18 1/4 x 18 1/4 (464 x 464)	9.9 4.5
18 x 24 (457 x 609)	18 1/4 x 24 1/4 (464 x 616)	12.6 5.7
20 x 20 (508 x 508)	20 1/4 x 20 1/4 (514 x 514)	12.1 5.5
22 x 22 (558 x 558)	22 1/4 x 22 1/4 (565 x 565)	13.4 6.1

Your odd sizes:
Made in 5 days

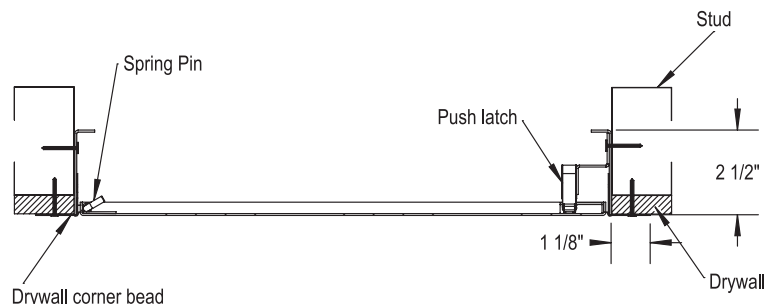

The **GFRG** is specially designed with rounded corners for a smooth finish. Since it is constructed with lightweight, glass fiber reinforced gypsum, it blends perfectly with drywall surfaces. Once painted, it creates an aesthetically pleasing finish. The gravity based panel closure, with removable door, makes it ideal for drywall ceiling applications

DESCRIPTION

- Material:** Lightweight glass fiber reinforced gypsum
- Hinge:** No hinge
Gravity based closure and removable door
- Finish:** Rounded corners (radius finish)
To be primed and sealed on site
- Packaging:** Individually wrapped. 1 per box

POPULAR OPTIONS

- Style:** Square corners
Hinges
Round door
- Lock / latch:** Cylinder, screwdriver latch
- Gasketing:** Gasketing (neoprene gasket).

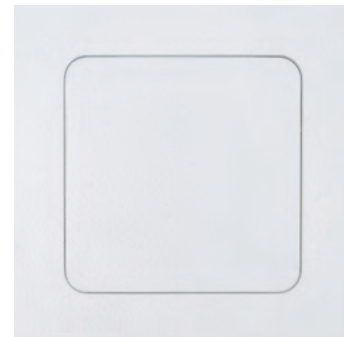

IDEAL FOR DRYWALL CEILING APPLICATION

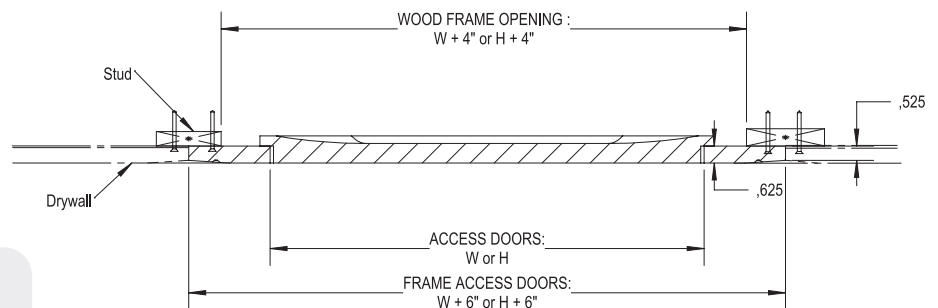

Table of standard sizes

[other sizes available upon request]

DOOR SIZE W x H inches (MM)	ROUGH CEILING OPENING inches	WEIGHT LBS	KG
9 x 9 (229 x 229)	15 x 15 (381 x 381)	6	2.72
12 x 12 (304 x 304)	18 x 18 (457 x 457)	8	3.63
16 x 16 (406 x 406)	22 x 22 (559 x 559)	10	4.54
18 x 18 (457 x 457)	24 x 24 (609 x 609)	11	4.99
24 x 24 (609 x 609)	30 x 30 (762 x 762)	16	7.26

Your odd sizes:
Made in 15 days

The **ALUMI** is solidly built with an extruded, mill finish aluminum frame and door contour with a moisture resistant drywall insert. The gasketed door perimeter restricts air and smoke infiltration. A concealed free pivot hinge and retaining cables allow for easy removal of the door; and the locking mechanism consists of hidden push latches

DESCRIPTION

Material: Extruded mill finish aluminum frame and door contour with moisture resistant drywall insert

Hinge: Concealed free pivot hinge, retaining cables and removable door

Lock / latch: Concealed push-latch

Removable door: Retaining cables included

Packaging: Individually wrapped. 1 per box

POPULAR OPTIONS

Lock / latch: Cylinder or screwdriver latch

Gasketing: Perimeter gasket

Finish: Factory taped, primed door

Elegance collection

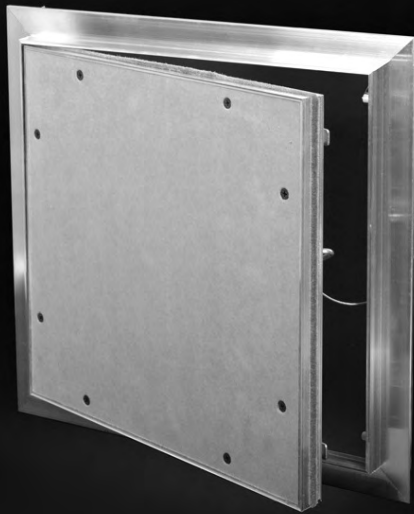

CONCEALED ACCESS DOORS

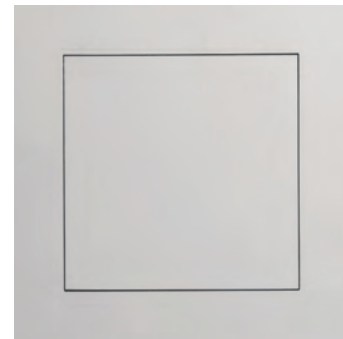

SOLIDLY BUILT EXTRUDED ALUMINUM FRAME AND DOOR

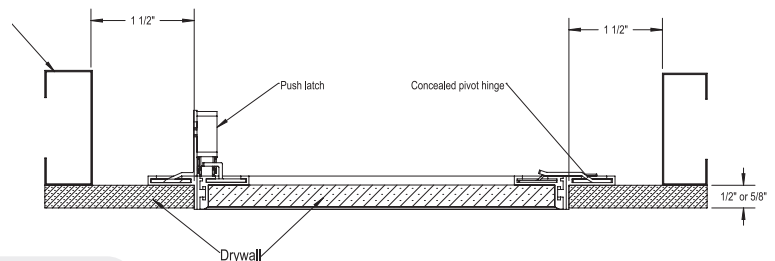

Table of standard sizes [other sizes available upon request]

DOOR SIZE W x H inches (MM)	ROUGH CEILING OPENING inches	WEIGHT DRYWALL 1/2 PO		WEIGHT DRYWALL 5/8 PO	
		LBS	KG	LBS	KG
8 x 8 (203 x 203)	8 3/8 x 8 3/8 (213 x 213)	2,3	1	2,8	1,3
12 x 12 (304 x 304)	12 3/8 x 12 3/8 (314 x 314)	3,5	1,6	4,4	2
16 x 16 (406 x 406)	16 3/8 x 16 3/8 (416 x 416)	4,9	2,2	6,5	3
18 x 18 (457 x 457)	18 3/8 x 18 3/8 (467 x 467)	5,8	2,6	7,8	3,5
20 x 20 (508 x 508)	20 3/8 x 20 3/8 (518 x 518)	6,7	3	9,1	4,1
24 x 24 (609 x 609)	24 3/8 x 24 3/8 (619 x 619)	8,8	4	12,2	5,5
36 x 36 (914 x 914)	36 3/8 x 36 3/8 (924 x 924)	16,9	7,7	24,2	11
24 x 48 (609 x 1219)	24 3/8 x 48 3/8 (619 x 1229)	15,5	7	22,1	10

Your odd sizes:
Made in 15 days

Unlike most existing access doors, the **FLE** door is adjustable to the size of the opening; offering a flush-mounted, metal panel that is durable and versatile. Installing the door is quick and easy and requires minimal tools. The **FLE** door is also aesthetically superior and it is offered in two models, one with a screwdriver lock and one without.



Front view

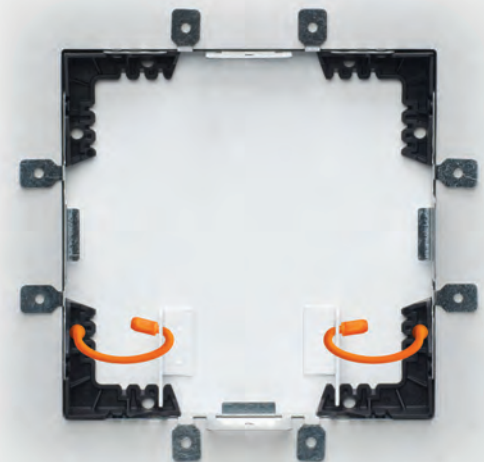

Rear view

Always install the security cables



DESCRIPTION

- Material:** Door panel: 20 gauge cold rolled steel
Frame: 24 gauge galvanized steel frame with notched knock-over tabs
Corners: polymer
- Lock / latch:** 4 magnets, 1 per corner
- Cables:** 2 security cables
- Finish:** high quality white powder coat primer
- Packaging:** individually wrapped, 4 per box
- **FLE-PRO:** individually wrapped, 1 per box

LEED ready: This product contributes to LEED® credits.
Visit www.cendrex.com for more information.

MULTIPACK



QUICK & EASY INSTALLATION

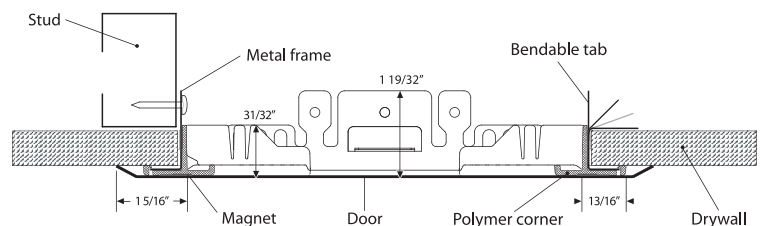

Table of standard sizes

PRODUCT CODE	INCHES	FOR OPENINGS - W x H (MM)	SHIPPING WEIGHT	
			LBS	KG
FLE 6.5X8-W	6.5 x 6.5 to 8 x 8	(165 x 165 to 203 x 203)	7	3.8
FLE 10.5X12-W	10.5 x 10.5 to 12 x 12	(267 x 267 to 305 x 305)	13	5.9
FLE 14X15.5-W	14 x 14 to 15.5 x 15.5	(356 x 356 to 394 x 394)	17.48	7.93

Table of standard sizes

PRODUCT CODE	INCHES	FOR OPENINGS - W x H (MM)	SHIPPING WEIGHT	
			LBS	KG
FLE-PRO 6.5X8	6.5 x 6.5 to 8 x 8	(165 x 165 to 203 x 203)	1.15	0.52
FLE-PRO 10.5X12	10.5 x 10.5 to 12 x 12	(267 x 267 to 305 x 305)	3.40	1.54
FLE-PRO 14X15.5	14 x 14 to 15.5 x 15.5	(356 x 356 to 394 x 394)	4.16	1.89

The **CTR** is the **newest generation of all purpose access doors**. Easy to install, it will blend into all non-rated surfaces better than any other door. Its special European type hinge allows the door, with its beveled edges, to close over the flange thus avoiding the additional labor to mud or plaster over the flange. The CTR features a truly cohesive appearance due to its well-integrated design of concealing the space between the panel and the flange.



**A LABOR SAVING
alternative to doors
with DRYWALL FLANGES**

“No need to mud or plaster”

DESCRIPTION

Material: 16 gauge cold rolled steel
Hinge: concealed, exclusive hinge design
Lock / latch: screwdriver operated cam latch
Finish: high quality white powder coat primer
Packaging: individually wrapped, 1 per box

POPULAR OPTIONS

[see p. 20-23 for complete list of options]

Material: stainless steel 304 #4 (brushed finish), galvaneal steel
Lock / latch: key operated cylinder cam latch, hex head cam latch, pinned hex head cam latch, handle operated cam latch, mortise preparation for cylinder. (cylinder optional)
Gasketing: neoprene gasket

RMD ACCESS DOOR

Removable access door with hidden flange is ideal for confined spaces where access is limited or where a pivoting door panel cannot be used due to an obstruction.

LEED ready: This product contributes to LEED® credits.
 Visit www.cendrex.com for more information.

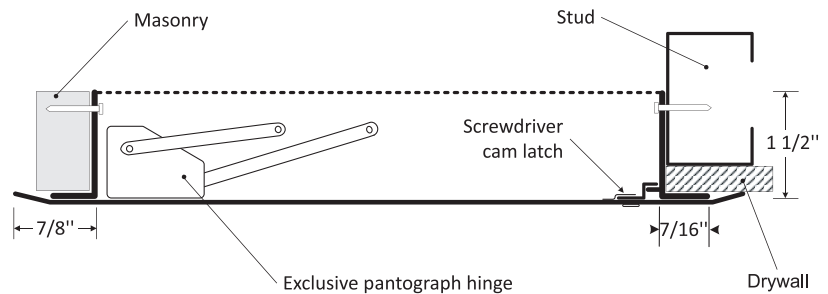

Table of standard sizes

[other sizes available upon request]

DOOR SIZE - W x H INCHES (MM)	NUMBER OF LOCKS	SHIPPING WEIGHT	
		LBS	KG
8 1/4 x 8 1/4 (210 x 210)	1	3	1.4
8 1/4 x 12 (210 x 304)	1	4	1.8
10 x 10 (254 x 254)	1	4	1.8
12 x 12 (304 x 304)	1	6	2.7
14 x 14 (355 x 355)	1	7	3.2
12 x 18 (304 x 457)	1	8	3.6
16 x 16 (406 x 406)	1	9	4.1
18 x 18 (457 x 457)	3	10	4.5
18 x 24 (457 x 609)	4	13	5.9
20 x 20 (508 x 508)	4	13	5.9
22 x 22 (558 x 558)	4	15	6.8
22 x 30 (558 x 762)	5	17	7.7
22 x 36 (558 x 914)	5	19	8.6
24 x 24 (609 x 609)	4	17	7.7
24 x 30 (609 x 762)	5	19	8.6
24 x 36 (609 x 914)	5	24	10.9
30 x 30 (762 x 762)	5	25	11.3

Rough wall opening = door size + 1/4" or + 6mm

CTR HIDDEN FLANGE

CONCEALED APPEARANCE

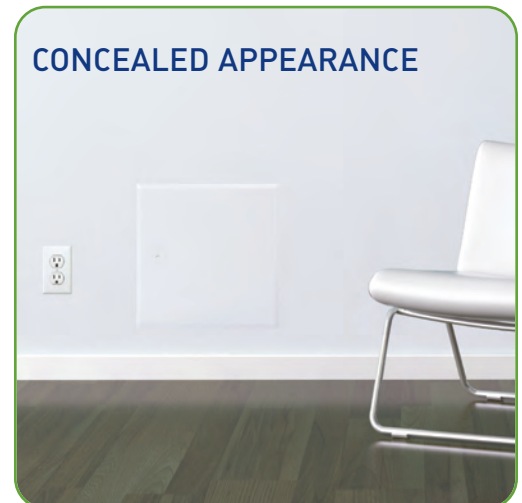

**Your odd sizes:
Made in 5 days**

The **AHD** is designed for a **quick and easy installation** on non-rated vertical and horizontal surfaces made of drywall or any other type of material. Its rounded mitered corners, concealed pin hinge and 3/8" return all around the door make it the sturdiest door on the market. The AHD prevents sagging, as compared to flat door panels, and requires fewer locks.



DESCRIPTION

- Material:** 16 gauge cold rolled steel
Hinge: hidden pin hinge
 continuous piano type on doors over 24" (height or width)
Lock / latch: screwdriver operated cam latch
Finish: high quality white powder coat primer
Packaging: individually wrapped, 1 per box

POPULAR

OPTIONS [see p. 20-23 for complete list of options]

- Material:** stainless steel 304 #4 (brushed finish), galvaneal steel
Lock / latch: key operated cylinder cam latch, hex head cam latch, pinned hex head cam latch, handle operated cam latch, mortise preparation for cylinder. (cylinder optional)
Gasketing: neoprene gasket

LEED ready: This product contributes to LEED® credits.
 Visit www.cendrex.com for more information.

Table of standard sizes

[other sizes available upon request]

PRODUCT CODE	DOOR SIZE W x H inches (MM)	NUMBER OF LOCKS	SHIPPING WEIGHT	
			LBS	KG
AHD	6 x 6 (152 x 152)	1	2	0.9
AHD/GYP/PLY	8 x 8 (203 x 203)	1	3	1.4
AHD	8 x 12 (203 x 304)	1	4	1.8
AHD/GYP/PLY	10 x 10 (254 x 254)	1	4	1.8
AHD/GYP/PLY	12 x 12 (304 x 304)	1	5	2.3
AHD	12 x 16 (304 x 406)	1	6	2.8
AHD	12 x 18 (304 x 457)	1	7	3.2
AHD	12 x 24 (304 x 609)	1	8	3.6
AHD/GYP/PLY	14 x 14 (356 x 356)	1	7	3.2
AHD/GYP/PLY	16 x 16 (406 x 406)	1	8	3.6
AHD/GYP/PLY	18 x 18 (457 x 457)	1	10	4.5
AHD	18 x 24 (457 x 609)	1	13	5.9
AHD	20 x 20 (508 x 508)	1	11	5
AHD	22 x 22 (558 x 558)	1	13	5.9
* AHD	22 x 30 (558 x 762)	2	17	7.7
* AHD	22 x 36 (558 x 914)	2	19	8.6
* AHD/GYP/PLY	24 x 24 (609 x 609)	1	15	6.8
* AHD	24 x 30 (609 x 762)	2	20	9.1
* AHD/GYP/PLY	24 x 36 (609 x 914)	2	22	10
* AHD	24 x 48 (609 x 1219)	2	28	12.7
* AHD	30 x 30 (762 x 762)	4	23	10.4
* AHD	36 x 36 (914 x 914)	4	31	14.1

The LHD model is recommended for over 36 x 36 - See page 14

Rough wall opening = door size + 1/4" or + 6mm

*Piano hinge on doors over 24 inches (height or width)

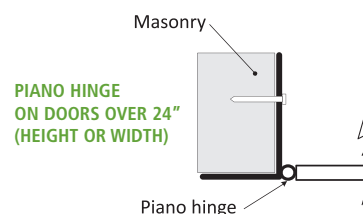
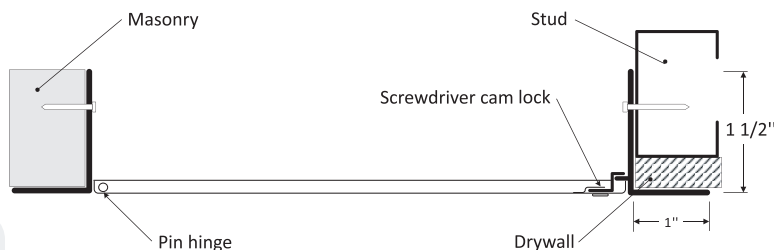

AHD-GYP



**FLUSH ACCESS DOOR
WITH DRYWALL
BEAD FLANGE**

**Your odd sizes:
Made in 5 days**

SFM

FLUSH UNIVERSAL SURFACE MOUNTED ACCESS DOOR - WITH EXPOSED FLANGE

MULTIPURPOSE

The **SFM** does **not** require any framing or cutting of inner wall obstructions. It is designed to sit directly on the wall and can be installed easily with fasteners on the 4 corners.



Your odd sizes:
Made in 5 days

Table of standard sizes

[other sizes available upon request]

DOOR SIZE - W x H INCHES (MM)	CLEAR INSIDE OPENING INCHES (MM)	NUMBER OF LOCKS	SHIPPING WEIGHT LBS KG
8 x 8 (203 x 203)	7 3/4 x 7 (197 x 178)	1	3 1.4
12 x 12 (304 x 304)	11 3/4 x 11 (298 x 279)	1	5 2.3
16 x 16 (406 x 406)	15 3/4 x 15 (400 x 381)	1	8 3.6
* 18 x 18 (457 x 457)	17 3/4 x 17 (451 x 432)	1	10 4.5
* 24 x 24 (609 x 609)	23 3/4 x 23 (603 x 584)	2	15 6.8

*Not recommended for ceilings

DESCRIPTION

Material: 16 gauge cold rolled steel
Hinge: continuous piano hinge
Lock / latch: screwdriver operated cam latch
Finish: high quality white powder coat primer
Packaging: individually wrapped, 1 per box

POPULAR OPTIONS

[see p. 20-23 for complete list of options]

Material: stainless steel 304 #4 (brushed finish),
galvanneal steel
Lock / latch: key operated cylinder cam latch,
hex head cam latch,
pinned hex head cam latch

LEED ready: This product contributes to LEED® credits.
Visit www.cendrex.com for more information.

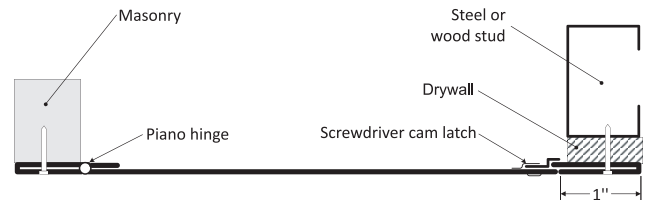

RPL

FLUSH UNIVERSAL REMOVABLE PLASTIC ACCESS DOOR - WITH EXPOSED FLANGE

MULTIPURPOSE

The **RPL** is a **removable high impact ABS plastic access panel** with UV stabilizers. It can be used for access to plumbing, electrical and other types of wiring, computer cables and sprinkler systems. Its reversible frame allows for flush or surface mounting.



DESCRIPTION

Material: high impact ABS plastic with UV stabilizers
Lock / latch: snap friction catch
Finish: white textured finish
Packaging : individually wrapped, 1 per box

Installation: adhesive caulking recommended

Table of standard sizes

ACCESS DOOR CODE	DOOR SIZE (A" x B")	WALL OPENING (E" x F")	FRAME SIZE TO OUTER FLANGE (C" x D")	SHIPPING WEIGHT LBS KG
6 x 9	6 x 9	6 3/8 x 9 3/8	8 1/4 x 11 1/4	0.5 0.23
8 x 8	8 x 8	8 3/8 x 8 3/8	10 1/4 x 10 1/4	0.5 0.23
14 x 14	13 3/4 x 13 3/4	14 x 14	17 x 17	1.95 0.88
14 x 29	13 3/4 x 29	14 x 29 1/2	17 x 32 1/4	4.55 2

The **PFI** is **insulated with 2" thick mineral wool** and can be used on fire rated **walls** and **ceilings**. It comes with a 1" flange for an easy flush installation on any type of surface. As per **UL** and **NFPA 80** standards, once the installation is complete and the provided springs are hooked to the back of the panel, the door will be self closing and self locking. The largest fire rated PFI doors available for vertical and horizontal installations are respectively: (48" x 48" or 2304 sq. in.) and (24" x 36" or 864 sq. in.).



PFI-GYP
FIRE-RATED INSULATED ACCESS DOOR WITH DRYWALL FLANGE



Tool key



Ring key



SUPPORT BRACKET required for ceiling installation

Table of standard sizes

[other sizes available upon request]

DOOR SIZE - W x H INCHES (MM)	NUMBER OF LOCKS	SHIPPING WEIGHT	
		LBS	KG
8 x 8 (203 x 203)	1	7	3.2
10 x 10 (254 x 254)	1	8	3.6
12 x 12 (304 x 304)	1	10	4.5
14 x 14 (355 x 355)	1	12	5.4
16 x 16 (406 x 406)	1	14	6.4
18 x 18 (457 x 457)	1	17	7.7
22 x 22 (558 x 558)	1	20	9.1
22 x 30 (558 x 762)	1	30	13.6
22 x 36 (558 x 914)	2	34	15.5
24 x 24 (609 x 609)	1	28	12.7
24 x 36 (609 x 914)	2	36	16.4
* 24 x 48 (609 x 1219)	2	48	21.8
* 30 x 30 (762 x 762)	1	40	18.1
* 32 x 32 (812 x 812)	2	43	19.5
* 36 x 36 (914 x 914)	2	50	22.7
* 48 x 48 (1219 x 1219)	2	83	37.7

Rough wall opening = door size + 1/4" or + 6mm

*Not available for ceiling rating with temperature rise (max. 24"X36")

DESCRIPTION

FIRE RATING: For installation in vertical wall assemblies:

CERTIFIED TO STANDARDS: UL 10C, UL 10B (2009), NFPA 252 (2012), CAN/ULC S104 (R1985), CAN/ULC S104 (2010).

RATING ACHIEVED: 3 hours

MAXIMUM SIZE: 48" wide x 48" high (1219 mm x 1219 mm).

Maximum area of 2304 in².

Tolerance on height and width limitation is ± 3" (76 mm) as long as the area does not exceed 2304 in².

TEMPERATURE RISE: 250°F (121°C) after 30 min.

450°F (232°C) after 60 min.

FIRE RATING: For installation in horizontal ceiling assemblies:

CERTIFIED TO STANDARDS: ASTM E119 (2012), CAN/ULC S101 (2007). RATING ACHIEVED: 3 hours in non-combustible construction.

1 hour in combustible construction.

MAXIMUM SIZE: 24" x 36" (610 mm x 914 mm) (hinges and latches on the side of 36"), tolerance on dimension limitations are more or less 3" (76 mm) as long as the area does not exceed 864 in². If door size exceeds 24" x 36", the latter is not fire-rated for ceiling installation.

All dimensions are written in the following order: Width x Height.

TEMPERATURE RISE: Not applicable.

Material: 16 gauge cold rolled steel frame and 20 gauge galvalneal steel door

Insulation: mineral wool

Hinge: continuous piano hinge

Lock / latch: self latching tool-key operated slam latch and/or ring operated slam latch, both included

Inside panel release: standard on all doors over 12" x 12"

Automatic panel closer: standard on all doors

Finish: high quality white powder coat primer

Packaging: individually wrapped, 1 per box

POPULAR OPTIONS

[see p. 20-23 for complete list of options]

Material: stainless steel #4 (brushed finish)

Lock / latch: handle operated slam latch, mortise preparation for cylinder (cylinder optional), hex head slam latch, mortise deadbolt lock

Masonry anchor: available on all sizes

PFI-HS SECURITY

for high security PFI-HS: optional 16 gauge cold rolled steel frame and 14 gauge galvalneal steel door

LEED ready: This product contributes to LEED® credits.

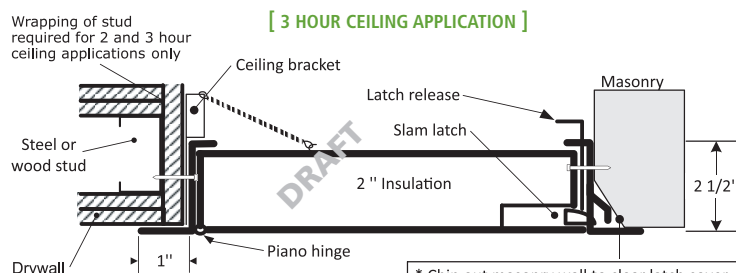

* The latch release allows the opening of the door from inside.

Authorities Having Jurisdiction (AHJ) should be consulted in all cases as to the particular requirements covering the installation and use of fire rated access doors.

**Your odd sizes:
Made in 5 days**

The **PFU** is designed to be installed on fire rated ceilings only. It can easily replace spring loaded models like the PFI. The door panel, which does not exceed 89 degrees of upward opening, falls back by law of gravity into its locked position as required by fire certification standards. Holding the door open while climbing through it becomes much easier with no springs to deal with. The largest fire rated PFU available is: (24" x 36" or 864 sq. in.).

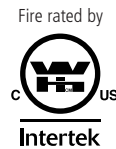

DESCRIPTION

FIRE RATING: For horizontal ceiling assemblies only: CERTIFIED TO STANDARDS: ASTM E119 (2012), CAN/ULC S101 (2007).
RATING ACHIEVED: 3 hours in non-combustible construction. 1 hour in combustible construction.
MAXIMUM SIZE: 24" x 36" (hinges & latch on 36" long sides) (610 mm x 914 mm). Tolerances on dimension limitations are $\pm 3"$ (76 mm) as long as the area does not exceed 864 in².
TEMPERATURE RISE: Not applicable.

Material: 16 gauge cold rolled steel frame and 20 gauge galvalume steel door
Insulation: mineral wool
Hinge: continuous piano hinge allows opening to 89°
Lock / latch: self latching ring operated slam latch inside and a hex head slam latch outside
Finish: high quality white powder coat primer
Packaging : individually wrapped, 1 per box

POPULAR OPTIONS [see p. 20-23 for complete list of options]

Material : stainless steel #4 (brushed finish)

LEED ready: This product contributes to LEED® credits. Visit www.cendrex.com for more information.



Wrapping of stud required for 2 and 3 hour ceiling applications only

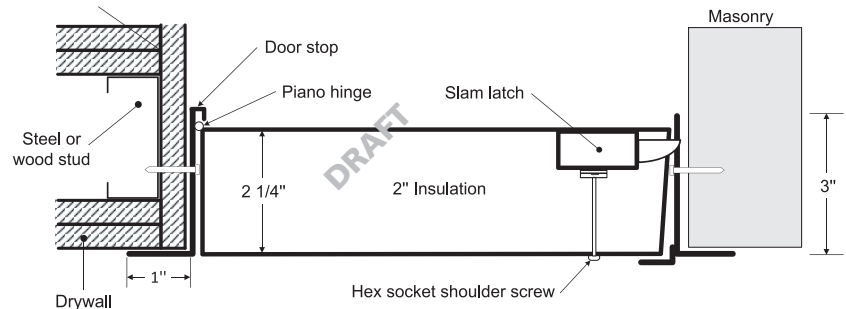

Authorities Having Jurisdiction (AHJ) should be consulted in all cases as to the particular requirements covering the installation and use of fire rated access doors.

[3 HOUR CEILING APPLICATION]

[1 HOUR CEILING APPLICATION]

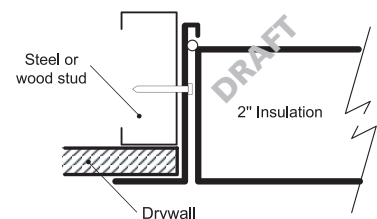

Table of standard sizes

[other sizes available upon request]

DOOR SIZE - W x H INCHES (MM)	NUMBER OF LOCKS	SHIPPING WEIGHT LBS KG
22 x 30 (558 x 762)	1	30 13.6
22 x 36 (558 x 914)	2	37 16.8
24 x 24 (609 x 609)	1	29 13.2

(Clear opening with door opened = W - 3 1/2")

Rough wall opening = door size + 1/4" or + 6mm

Your odd sizes:
Made in 5 days

The **PFN** is **not insulated** and can **only be used on fire rated walls**. It comes with a 1" flange for an easy flush installation on any type of surface material. As per **UL** and **NFPA 80** standards, once the installation is complete and the provided springs installed, this door will be self closing and self locking. It should not be used in situations where protection against temperature elevation is required. The largest fire rated PFN door available is: (36" x 36" or 1296 sq. in.).

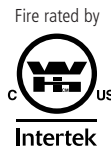

Table of standard sizes [other sizes available upon request]

DOOR SIZE - W x H INCHES (MM)	NUMBER OF LOCKS	SHIPPING WEIGHT	
		LBS	KG
8 x 8 (203 x 203)	1	5	2.3
10 x 10 (254 x 254)	1	7	3.2
12 x 12 (304 x 304)	1	8	3.6
14 x 14 (355 x 355)	1	10	4.5
16 x 16 (406 x 406)	1	12	5.5
18 x 18 (457 x 457)	1	14	6.4
22 x 22 (558 x 558)	1	18	8.2
22 x 30 (558 x 762)	1	22	10.0
22 x 36 (558 x 914)	2	27	12.2
24 x 24 (609 x 609)	1	22	10.0
24 x 36 (609 x 914)	2	29	13.2
30 x 30 (762 x 762)	1	30	13.6
32 x 32 (812 x 812)	2	33	15
36 x 36 (914 x 914)	2	39	17.7

Rough wall opening = door size + 1/4" or + 6mm

DESCRIPTION

FIRE RATING: For vertical wall assemblies only:
CERTIFIED TO STANDARDS: UL 10C, UL 10B (2009), NFPA 252 (2012), CAN/ULC S104 (R1985), CAN/ULC S104 (2010).

RATING ACHIEVED: up to 3 hours

MAXIMUM SIZE: 36" wide x 36" high (914 mm x 914 mm). Maximum area of 1296 in².

Tolerance on height and width limitation is $\pm 3"$ (76 mm) as long as the area does not exceed 1296 in².

TEMPERATURE RISE: No rating achieved.

Material: 16 gauge cold rolled steel

Hinge: continuous piano hinge

Lock / latch: self latching tool-key operated latch and/or ring operated latch, both included

Inside panel release: standard on all doors over 12" x 12"

Automatic panel closer: standard on all doors

Finish: high quality white powder coat primer

Packaging: individually wrapped, 1 per box

POPULAR OPTIONS

[see p. 20-23 for complete list of options]

Material: stainless steel 304 #4, galvanneal steel

Lock / latch: key operated slam latch, handle operated slam latch, mortise preparation for cylinder (cylinder optional), hex head slam latch, mortise deadbolt lock

Masonry anchor: available on all sizes

PFN-HS SECURITY

for high security PFN-HS: optional 16 gauge cold rolled steel frame and 14 gauge galvanneal steel door

LEED ready: This product contributes to LEED® credits.
Visit www.cendrex.com for more information.

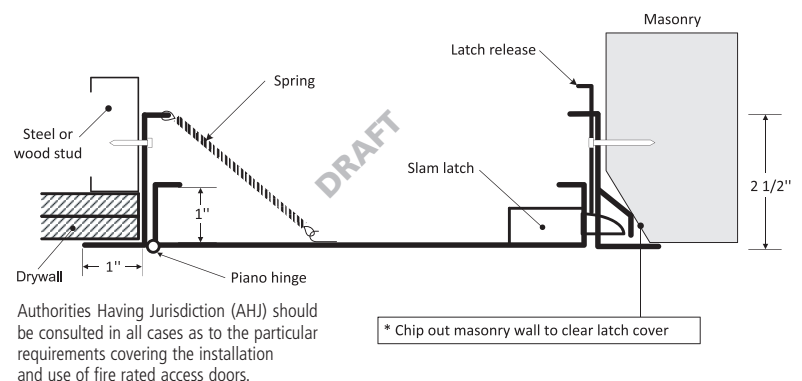

PFN-GYP



**FIRE-RATED
UNINSULATED
ACCESS DOOR
WITH DRYWALL
FLANGE**

**Your odd sizes:
Made in 5 days**

The **AHA's** standard 5/8" **recessed panel** will accept ceramic tiles, drywall panels, acoustical tiles or other materials to match the surface finish on which it is installed. It is also available in different recesses of up to 1 1/2" to accommodate multi layers of drywall.



DESCRIPTION

- Material:** 16 gauge cold rolled steel
- Hinge:** continuous piano hinge
- Lock / latch:** Allen hex head cam latch
- Finish:** high quality white powder coat primer
- Packaging:** individually wrapped, 1 per box
- Recess:** 5/8" standard

POPULAR OPTIONS

[see p. 20-23 for complete list of options]

- Material:** stainless steel 304 #4 (brushed finish), galvanized steel
- Latch:** key operated cylinder cam latch
- Recess:** 1/2" to 3/4" (standard 1 5/8" frame)
13/16" to 1 1/2" (special 2 1/2" frame)

LEED ready: This product contributes to LEED® credits.
Visit www.cendrex.com for more information.



AHA-GYP

**RECESSED ACCESS DOOR
WITH DRYWALL
BEAD FLANGE**

Table of standard sizes

[other sizes available upon request]

DOOR SIZE - W x H INCHES (MM)	NUMBER OF LOCKS	SHIPPING WEIGHT LBS KG
8 x 8 (203 x 203)	1	3 1.4
12 x 12 (304 x 304)	1	5 2.3
16 x 16 (406 x 406)	1	9 4.1
18 x 18 (457 x 457)	1	11 5
24 x 24 (609 x 609)	1	16 7.3

Rough wall opening = door size + 1/4" or + 6mm

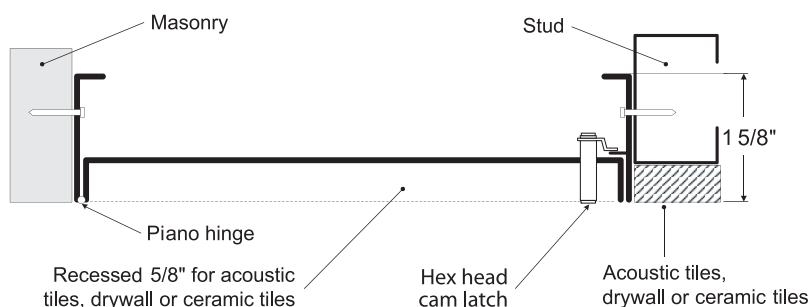

Your odd sizes:
Made in 5 days

The **LHD** door with its **2 1/2" deep frame** and heavy duty design is ideal for openings larger than the AHD can accommodate. It is also available in a double leaf version.



DESCRIPTION

- Material:** 16 gauge cold rolled steel
Hinge: continuous piano hinge
Lock / latch: self latching tool-key operated slam latch and/or ring operated slam latch, both included
Inside panel release: standard on all doors over 12" x 12"
Finish: high quality white powder coat primer
Packaging : individually wrapped, 1 per box

POPULAR OPTIONS

[see p. 20-23 for complete list of options]

- Material:** stainless steel 304 #4 (brushed finish), galvaneal steel
Lock / latch: key operated cylinder cam latch, handle operated slam latch, mortise preparation for cylinder (cylinder optional), mortise deadbolt lock
Design: double leaf

LEED ready: This product contributes to LEED® credits. Visit www.cendrex.com for more information.

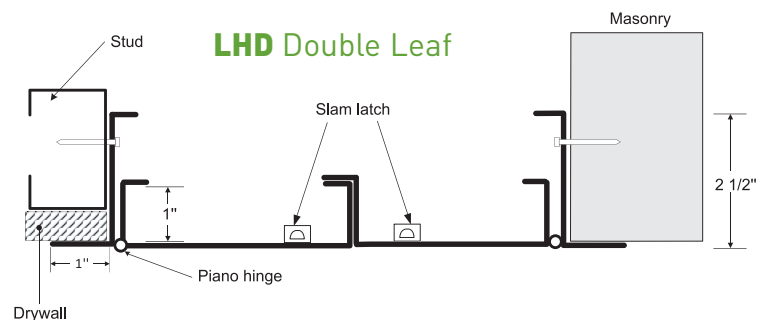
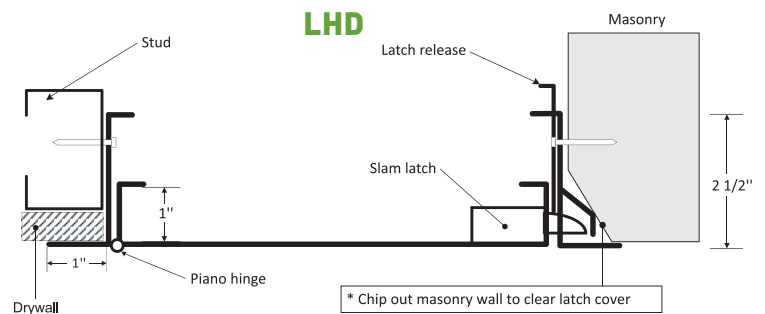

LHD-GYP



**HEAVY DUTY
ACCESS DOOR
FOR LARGE
OPENINGS
WITH DRYWALL
BEAD FLANGE**

Table of standard sizes

[any sizes available upon request]

Any size made in record time

Rough wall opening = door size + 1/4" or + 6mm

**Your odd sizes:
Made in 5 days**

LHD-180

**HEAVY DUTY
DOUBLE LEAF
ACCESS DOOR FOR
LARGE OPENINGS
WITH EXPOSED
FLANGE**



PAL

FLUSH UNIVERSAL INSULATED ALUMINUM ACCESS DOOR - WITH EXPOSED FLANGE

SPECIALTY

The **PAL door** with 1" fiberglass wool insulation and neoprene gasket is ideal to reduce sound and air transfers between partitions. The robust all aluminum construction allows for its use in large wall or ceiling openings and where corrosion and moisture are a concern.

Your odd sizes:
Made in 5 days

Table of standard sizes [other sizes available upon request]

DOOR SIZE - W x H INCHES (MM)	NUMBER OF LOCKS	SHIPPING WEIGHT LBS KG
8 x 8 (203 x 203)	1	2 0.9
12 x 12 (304 x 304)	1	3 1.4
16 x 16 (406 x 406)	1	6 2.7
18 x 18 (457 x 457)	1	7 3.2
24 x 24 (609 x 609)	1	13 5.9
24 x 36 (609 x 914)	2	17 7.7
36 x 36 (914 x 914)	2	21 9.5

Rough wall opening = door size + 1/4" or + 6mm



DESCRIPTION

Material: 0.064" aluminum
Insulation: 1" fiberglass wool
Hinge: aluminum continuous piano type
Gasketing: neoprene all around perimeter
Lock / latch: cylinder lock and key
Finish: high quality white powder coat primer
Packaging: individually wrapped, 1 per box

LEED ready

POPULAR OPTIONS [see p. 20-23 for options]

Material: stainless steel 304 #4, galvanneal steel
Lock / latch: screwdriver operated cylinder cam latch, mortise slam latch preparation (cylinder optional), handle operated cam latch

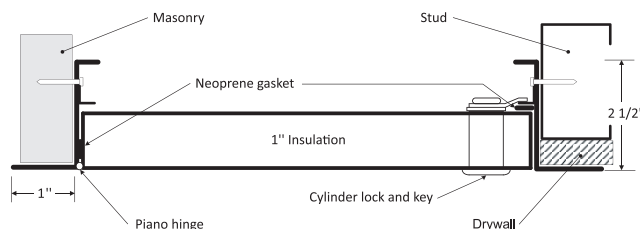

DRD

DRAFT STOP ACCESS DOOR FOR ATTIC APPLICATION - WITH EXPOSED FLANGE

SPECIALTY

The **DRD** is mainly designed to allow passage between attic sections while preventing back drafts from one to the other. Although not rated, it is self closing and self latching and can be opened from both sides.

Your odd sizes:
Made in 5 days

Table of standard sizes [other sizes available upon request]

DOOR SIZE - W x H INCHES (MM)	NUMBER OF LOCKS	SHIPPING WEIGHT LBS KG
22 x 30 (558 x 762)	1	22 10
22 x 36 (558 x 914)	2	28 12.2
24 x 36 (609 x 914)	2	29 14.1
24 x 48 (609 x 914)	2	37 16.8
24 x 60 (609 x 1524)	2	44 20
30 x 30 (762 x 762)	1	30 13.6
36 x 36 (914 x 914)	2	39 17.7
36 x 48 (914 x 1219)	2	49 22.2

Rough wall opening = door size + 1/4" or + 6mm



DESCRIPTION

Material: 16 gauge cold rolled steel
Hinge: continuous piano hinge
Lock / latch: self latching tool-key operated latch and/or ring operated latch, both included
Inside panel release: standard on all doors over 12" x 12"
Automatic panel closer: standard on all doors
Finish: high quality white powder coat primer
Packaging: individually wrapped, 1 per box

LEED ready

POPULAR OPTIONS [see p. 20-23 for options]

Material: stainless steel 304 #4, galvanneal steel
Lock / latch: key operated cylinder cam latch, handle operated slam latch, mortise preparation for cylinder (cylinder optional), mortise deadbolt lock
Gasketing: neoprene gasket

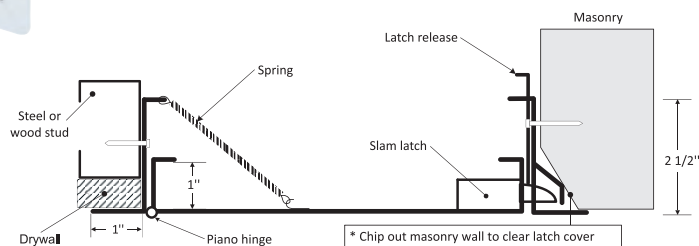

Thanks to its **beveled door panel**, the **BTA** valve box is practical and aesthetically pleasing. It comes in various sizes and depths and can be pre-drilled to accept water pipes, gas pipes and conduits. The **BTV** model comes with a **Plexiglass window**.



BTA
VALVE BOX
WITH HIDDEN
FLANGE



BTV
VALVE BOX,
PLEXIGLASS WINDOW
WITH HIDDEN
FLANGE

DESCRIPTION

- Material:** 16 gauge cold rolled steel
- Hinge:** concealed, exclusive hinge design
- Lock / latch:** screwdriver operated cam latch
- Finish:** high quality white powder coat primer
- Packaging:** individually wrapped, 1 per box
- Depth:** 4" or 6"
- Window:** 1/8" Plexiglass (BTV only)

POPULAR OPTIONS

[see p. 20-23 for complete list of options]

- Material:** stainless steel 304 #4 (brushed finish), galvaneal steel
- Lock / latch:** cylinder lock and key, Allen head hex lock
- Style:** surface mount cabinet (style AHD)
- Depth:** various depths available
- Unassembled:** door frame separate from cabinet

LEED ready: This product contributes to LEED® credits.
Visit www.cendrex.com for more information.

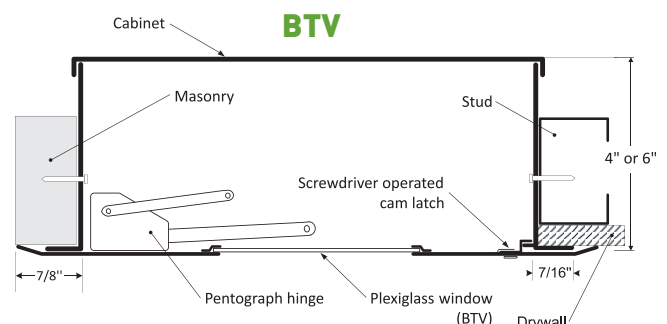
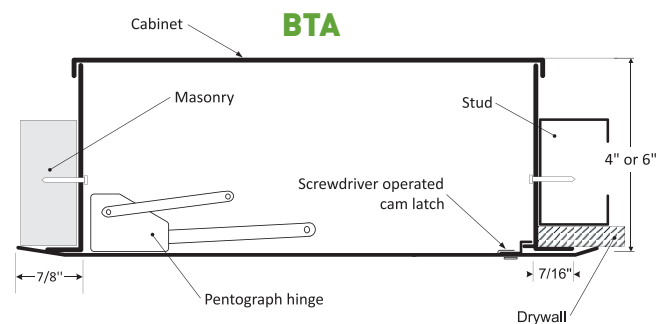

Table of standard sizes

[other sizes available upon request]

DOOR SIZE - W x H INCHES (MM)	WINDOW SIZE FOR BTV (approx.)	NUMBER OF LOCKS
8 1/4 x 8 1/4 (209 x 209)	3 x 3 (76 x 76)	1
12 x 12 (304 x 304)	5 x 5 (127 x 127)	1
16 x 16 (406 x 406)	8 x 8 (203 x 203)	1

Rough wall opening = door size + 1/2" or + 12.7mm

Your odd sizes:
Made in record time

MDS

MEDIUM SECURITY FLUSH UNIVERSAL ACCESS DOOR - WITH EXPOSED FLANGE

SECURITY

The **MDS** is a **non-rated flush door built for extra reinforcement**. It is constructed with thicker steel, a **continuous piano hinge** and a key operated cylinder cam latch. It is designed to ensure medium security wherever it may be required.

Your odd sizes:
Made in 5 days

Table of standard sizes [other sizes available upon request]

DOOR SIZE - W x H INCHES (MM)	NUMBER OF LOCKS	SHIPPING WEIGHT LBS KG
12 x 12 (304 x 304)	1	6 2.7
16 x 16 (406 x 406)	1	7 3.2
18 x 18 (457 x 457)	1	11 5
24 x 24 (609 x 609)	1	19 8.6
24 x 30 (609 x 762)	2	24 10.9
24 x 36 (609 x 914)	2	27 12.2
36 x 36 (914 x 914)	2	41 18.6

Rough wall opening = door size + 1/4" or + 6mm



DESCRIPTION

LEED ready

Material: 14 gauge galvalume steel
Hinge: continuous piano type
Lock / latch: key operated cylinder cam latch
Finish: high quality white powder coat primer
Packaging: individually wrapped, 1 per box

POPULAR OPTIONS [see p. 20-23 for options]

Material: stainless steel 304 #4 (brushed finish)
Lock / latch: mortise preparation for cylinder (cylinder optional), pinned hex head cam latch, 4" key handle operated cam latch, mortise deadbolt lock

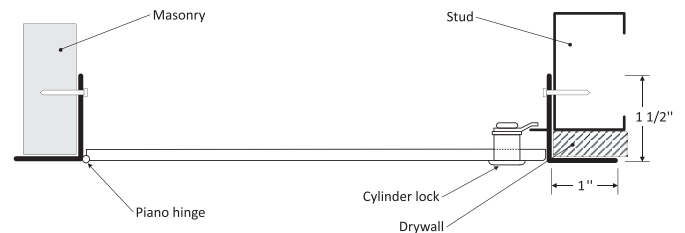

PHS

HIGH SECURITY FLUSH UNIVERSAL ACCESS DOOR - WITH EXPOSED FLANGE

SECURITY

The **PHS** is designed to be used in situations **where security is of the utmost importance**. It is manufactured with detention grade materials and can be prepped for all types of dead locks.

Your odd sizes:
Made in 5 days

Table of standard sizes [other sizes available upon request]

DOOR SIZE - W x H INCHES (MM)	SHIPPING WEIGHT LBS KG
12 x 12 (304 x 304)	22 10
16 x 16 (406 x 406)	30 13.6
18 x 18 (457 x 457)	34 15.4
24 x 24 (609 x 609)	49 22.2
24 x 30 (609 x 762)	57 25.9
24 x 36 (609 x 914)	65 29.5
36 x 36 (914 x 914)	86 39

Rough wall opening = door size + 1/4" or + 6mm



Shown with optional mortise deadbolt lock and cylinder

DESCRIPTION

LEED ready

Material: 10 gauge cold rolled steel plate
 2" x 2" x 3/16" thick angle frame
Hinge: 3" x 3" (13 Ga Steel) heavy duty butt hinges
 13 gauge cold rolled steel
Lock / latch: as per customer's request (see options)
Finish: high quality white powder coat primer
Packaging: individually wrapped, 1 per box

POPULAR OPTIONS [see p. 20-23 for options]

Lock / latch: mortise preparation (cylinder optional), mortise deadbolt lock, mortise preparation for detention lock

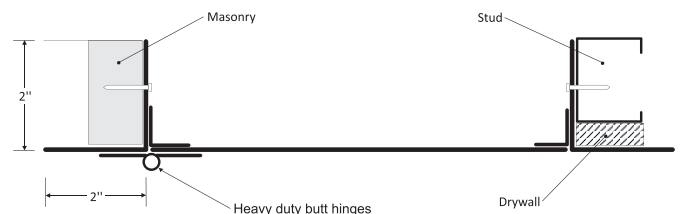

The **PPA** is built for interior use to provide a **reliable and secure access** between building floors. Its sturdy 1/4" thick diamond or smooth finish aluminum plate and 1/4" thick aluminum frame construction make it the ideal solution for either existing cement floors or poured-in-place concrete.

DESCRIPTION

Material: DOOR: 1/4" aluminum diamond plate
FRAME: 2" x 2" x 1/4" aluminum angle

Hinge: heavy duty aluminum continuous piano hinge (0.080")

Lock / latch: recessed handle operated cam latch

POPULAR OPTIONS [see p. 20-23 for complete list of options]

Lock / latch: Key operated recessed handle cam Latch

Recess: recessed floor hatch - see PPA-RE model
1/8", 3/16", 1/4", 3/8", 1/2", 5/8",
11/16" and 3/4"

Caution: The PPA floor hatch is designed to support a live load of 300 pounds/sq.foot and includes a hold open arm to keep the door in an open position.

LEED ready: This product contributes to LEED® credits.
Visit www.cendrex.com for more information.



PPA

**FLUSH
ALUMINUM
FLOOR HATCH
WITH EXPOSED
FLANGE**



PPA-RE

**RECESSED ALUMINUM
FLOOR HATCH
WITH EXPOSED
FLANGE**

Table of standard sizes

[other sizes available upon request]

HATCH SIZE - W x H INCHES (MM)	NUMBER OF LOCKS	SHIPPING WEIGHT LBS KG
24 x 24 (609 x 609)	1	35 15.9
24 x 36 (609 x 914)	1	44 20

Rough floor opening = door size + 1/2" or + 13mm

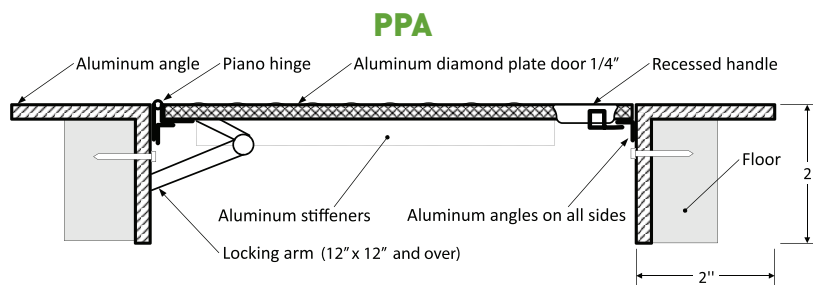

[FOR HATCHES > 24 X 36]

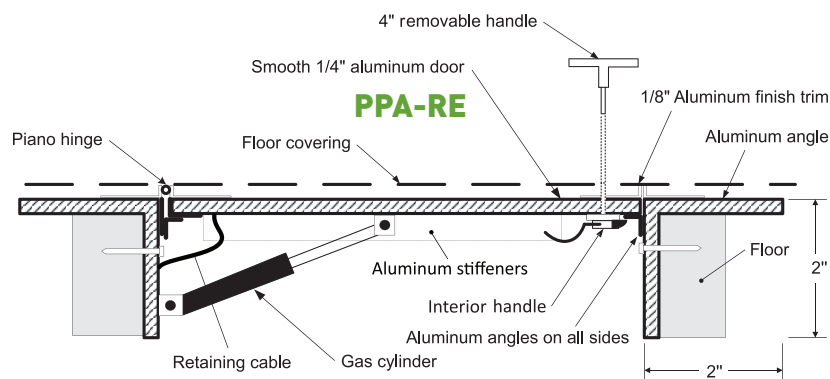

[FOR HATCHES > 18 X 18]

**Your odd sizes:
Made in 10 days**

The **TRH** roof hatch, made of galvalume steel, is designed to offer convenient access to building roof tops. It is equipped with gas cylinders providing an effortless opening of the door panel. Its heavy duty design and insulation ensure long life and low maintenance.



DESCRIPTION

- Cover:** 14 gauge galvalume steel with 1" fiberglass insulation
- Curb:** 14 gauge galvalume steel with 1" fiber board insulation
- Seal:** "D" - foam adhesive gasket provides a flush and tight fit
- Components:** 2 gas cylinders, retaining bar handles
- Finish:** high quality white powder coat primer
- LEED®:** When painted white, the TRH could contribute to meeting SSc7.2 (Heat Island Effect) requirements for highly reflective roofing materials.

POPULAR OPTIONS

[see p. 20-23 for complete list of options]

Material: aluminum

LEED ready: This product contributes to LEED® credits. Visit www.cendrex.com for more information.

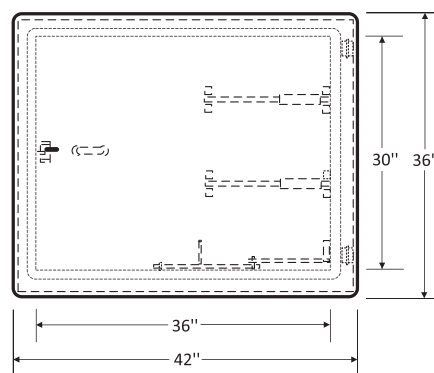
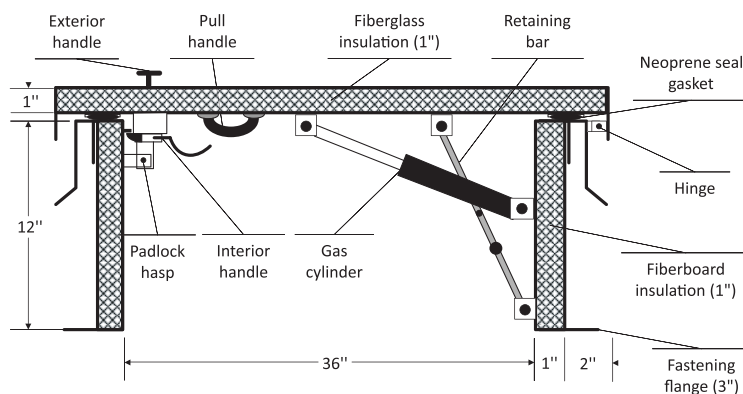

Table of standard sizes

[other sizes available upon request]

HATCH SIZE - W x H INCHES (MM)	EXTERIOR SIZE - W x H INCHES (MM)	NUMBER OF LOCKS	SHIPPING WEIGHT	
			LBS	KG
36 x 30 (914 x 762)	42 x 36 (1067 x 914)	1	178	81
36 x 36 (914 x 914)	42 x 42 (1067 x 1067)	1	188	85

Roof opening = size of roof hatch

Your odd sizes:
Made in 10 days

Options are available for ALL ACCESS PRODUCTS to better accommodate your needs and to provide specification compliance. In this section (p. 20-23) you will find the list of options, their codes and the complete chart.

- **OPTIONS:** Divided into 4 sections: LOCKS AND LATCHES, HANDLES, MATERIALS AND OTHER OPTIONS.
- **OPTIONS CODES:** Codes are in blue for easy identification and ordering purposes.
- **OPTIONS CHART:** Designed to inform you of the various options available for each product.

Please visit our website at www.cendrex.com for up-to-date options information.

MEDIUM AND HIGH SECURITY LOCKS AND LATCHES:



85 - MORTISE SLAM LATCH

The panel will accept cylinders 1 5/32" in diameter from most lock manufacturers (Best, Ilco, Corbin, etc). Enables the slam latch to operate with matching project hardware.
(CYLINDER OPTIONAL - 85C)



15 - MORTISE CAM LATCH

The panel will accept cylinders 1 5/32" in diameter from most lock manufacturers (Best, Ilco, Corbin, etc).
(CYLINDER OPTIONAL - 15C)



C - CYLINDER FOR DEADBOLT LOCK OR MORTISE

Keyed different is standard.
Keyed alike is optional. - CKA

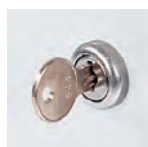

10 - KEY OPERATED CYLINDER CAM LATCH

Recommended for security access or where locks are required for controlled access.
Keyed alike is standard.
Keyed different is optional. - 10KD



40 - MORTISE DEADBOLT LOCK

Recommended for high security applications. The panel will accept cylinders 1 5/32" in diameter from most lock manufacturers (Best, Ilco, Corbin, etc).
(CYLINDER OPTIONAL - 40C)



99 - INSIDE RELEASE THUMBTURN FOR MORTISE DEADBOLT LOCK

Allows the door to be opened from the inside of the panel. Serves as a safety mechanism.
(Available only with - 40)



45 - MORTISE PREPARATION FOR DETENTION DEADBOLT LOCK



46 - DETENTION DEADBOLT LOCK



47 - DETENTION DEADBOLT KEY



90 - PINNED HEX HEAD CAM LATCH

Recommended for more secure applications. Requires a special pinned allen key to open the access door. Key sold separately.

AK-90 - ALLEN KEY FOR PINNED HEX HEAD CAM LATCH

REGULAR LATCHES:



35 - SCREWDRIVER CAM LATCH

Standard on general purpose access doors. Available in cold rolled steel, stainless steel and galvaneal steel.



50 - HEX HEAD CAM LATCH

Requires a standard allen key to open the access door. Offers added security. Key sold separately.

AK-50 - ALLEN KEY



80 - RING/TOOL KEY OPERATED SLAM LATCH

Standard latching mechanism on all our fire rated models. It allows the door to shut by itself when attached with a spring.



55 - HEX HEAD SLAM LATCH

Requires a standard allen key to open the access door. Offers added security. Key sold separately.

AK-55 - ALLEN KEY



220 - SCREWDRIVER OPERATED CYLINDER CAM LATCH

Available for PAL and LHD models only.



30 - SLIDE LATCH

Allows the door to be opened using a simple sliding action.

OPTION ↓	MODEL →	MULTI PURPOSE				FIRE RATED			RECESSED		SPECIALTY		SECURITY			FLOOR HATCH	ROOF HATCH
		FLE	CTR	AHD	SFM	PFI	PFU	PFN	AHA	LHD	PAL	DRD	BTA BTV	MDS	PHS	PPA	TRH
C	CYLINDER FOR DEADBOLT LOCK OR MORTISE		●	●		●		●		●	●	●	●	●	●		●
10	KEY OPERATED CYLINDER CAM LATCH		●	●	●	●		●	● ¹	●	std.	●	●	std.			
15	MORTISE CAM LATCH		●	●									●	●			
30	SLIDE LATCH		●	●									●				
35	SCREWDRIVER CAM LATCH		std.	std.	std.								std.	●			
40	MORTISE DEADBOLT LOCK		●	●		●		●		●	●	●	●	●	●		●
45	MORTISE PREPARATION FOR DETENTION LOCK														●		
46	DETENTION DEADBOLT LOCK														●		
50	HEX HEAD CAM LATCH		●	●	●				std.				●	●			
55	HEX HEAD SLAM LATCH		●	●		●	std.	●		●	●	●	●	●			
80	RING/TOOL KEY OPERATED SLAM LATCH		●	●		std.		std.		std.	●	std.	●	●			
85	MORTISE SLAM LATCH		●	●		●		●		●	●	●	●	●			
90	PINNED HEX HEAD CAM LATCH		●	●	●				●				●	●			
220	SCREWDRIVER OPERATED CYLINDER CAM LATCH									●	●						

● = Option available

std. = Standard feature

1 - Maximum recess of 13/16"

OPTIONS

HANDLES, MATERIALS

HANDLES:



20
4" HANDLE OPERATED CAM LATCH



21
FIXED 4" HANDLE



22
4" HANDLE OPERATED SLAM LATCH



25
4" HANDLE AND KEY OPERATED CAM LATCH



26
L HANDLE
Allows the door to be opened from the inside of the panel.
Available only in combination with options 20, 22 or 25.



100K
KEY OPERATED RECESSED HANDLE CAM LATCH
Available for PPA model only.

		MULTI PURPOSE				FIRE RATED			RECESSED		SPECIALTY		SECURITY			FLOOR HATCH		ROOF HATCH
OPTION ↓	MODEL →	FLE	CTR	AHD	SFM	PFI	PFU	PFN	AHA	LHD	PAL	DRD	BTA BTV	MDS	PHS	PPA	TRH	
20	4" HANDLE OPERATED CAM LATCH		●	●	●				● ¹	●	●		●	●				
21	FIXED 4" HANDLE		●	●	●	●		●	● ¹	●	●	●	●	●	●		std.	
22	4" HANDLE OPERATED SLAM LATCH		●	●		●		●		●	●	●	●	●			std.	
25	4" KEY HANDLE OPERATED CAM LATCH		●	●	●				● ¹	●	●		●	●	●			
26	L HANDLE		● ²	● ²				● ⁴		● ²	● ²	● ²		● ²				
100K	KEY RECESSED HANDLE CAM LATCH															● ³		

1 - Provided, not installed. 2 - Available only in combination with options 20, 22 or 25.

3 - Not available for PPA recessed model. 4 - Available only in combination with option 22.

MATERIALS:

GALVANNEAL STEEL (SATIN COATED) - GS - ALUMINUM - AL

STAINLESS STEEL - SS - COLD ROLLED STEEL - CR

OPTION ↓	MODEL →	FLE	CTR	AHD	SFM	PFI	PFU	PFN	AHA	LHD	PAL	DRD	BTA BTV	MDS	PHS	PPA	TRH
GS	GALVANNEAL STEEL		●	●	●	std. door	std. door	●	●	●	●	●	●	std.			std.
AL	ALUMINUM										std.					std.	●
SS	STAINLESS STEEL		●	●	●	●	●	●	●	●	●	●	●	●			
CR	COLD ROLLED STEEL	std. door	std.	std.	std.	std. frame	std. frame	std.	std.	std.		std.	std.	●	std.		

OTHER OPTIONS:



60 - GASKET

Recommended to provide weather resistance and to reduce airflow between the panel and frame.



110 - CONTINUOUS PIANO HINGE

Standard on our fire rated doors and usually recommended for use on larger doors. It provides specification compliance when required. Available in cold rolled steel or stainless steel.



140 - LOUVERED DOORS

Allows ventilation for special applications.



160 - HOLDING CABLE



180 - DOUBLE LEAF

Recommended for access to large openings.



240 - MASONRY ANCHORS

Recommended to secure the door in place when installed in masonry.



GY - DRYWALL FLANGE

Only the door will be visible when drywall compound is applied to the corner bead flange.



PLY - PLASTER FLANGE

The 2 3/4" lath flange will disappear when covered with plaster, leaving only the door panel visible.



OTHER OPTIONS AVAILABLE UPON REQUEST

		MULTI PURPOSE				FIRE RATED			RECESSED		SPECIALTY		SECURITY			FLOOR HATCH		ROOF HATCH
OPTION ↓	MODEL →	FLE	CTR	AHD	SFM	PFI	PFU	PFN	AHA	LHD	PAL	DRD	BTA BTV	MDS	PHS	PPA	TRH	
60	GASKET		●	●		●		●	●	●	std.	●	●	●	●		std.	
110	CONTINUOUS PIANO HINGE			opt. ≤24" std. >24"	std.	std.	std.	std.	std.	std.	std.	std.	● ¹	std.		std.		
140	LOUVERED DOORS		●	●	●					●		●	●	●				
160	HOLDING CABLE		●	●	●				●	●	●		●	●				
180	DOUBLE LEAF			●						●	●	●	● ²	●				
240	MASONRY ANCHORS		●	●		●		●	●	●	●	●	●	●	●			
GY	DRYWALL FLANGE			●		●		●	●	●		●						
PLY	PLASTER FLANGE			●		●		●	●	●		●						

1 - Standard on surface mounted cabinet (style AHD) over 24" in height or width.

2 - Surface mounted only.

THE CENDREX ADVANTAGE:

Since 1985, Cendrex designs and manufactures high quality rated and non-rated access doors, roof hatches, floor hatches and mailboxes.

- EXCEPTIONAL RELIABILITY
- ODD SIZE DOORS IN 5 DAYS
- CUSTOM DOORS IN 10 DAYS
- FAST AND EASY INSTALLATION
- EXCEPTIONAL PRODUCTS
- GREAT PRODUCT AVAILABILITY
- LEED READY
- ENJOY FIRST-RATE SALES SUPPORT
- SAVE TIME WITH CENDREX WEB TOOLS

cendrex

WAREHOUSES



info@cendrex.com

Tel.: 1 800 479-1489

www.cendrex.com
www.flexisnap.com